

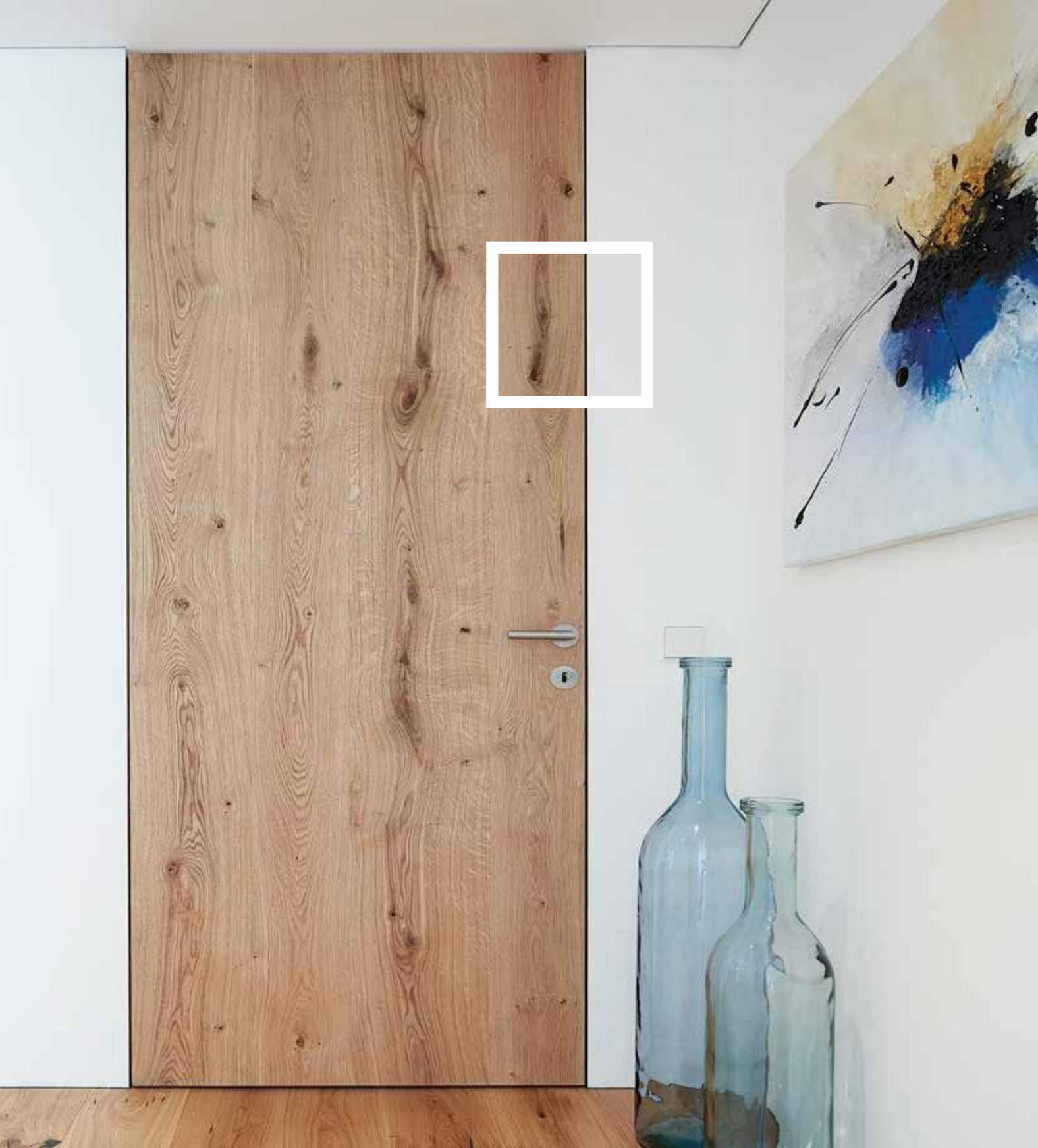

Concealed door frames for stud and block walls

architrave-free design
for a more contemporary look





Solution at highest level for design lovers



Every door is special
individual, unique, elegant
the door as a design element

No more gap-filling sealants

Architrave-free doorways are an important feature of modern building design, to give rooms a more spacious and uncluttered look. But a door is a moving part of the building, and architraves were designed to conceal the vibration cracks around the door frame.

AGS has overcome this problem for concealed door frames with an integral plastering reinforcement mesh, that bonds the frame to the wall in a permanent way. No cracks, no frame sealants!

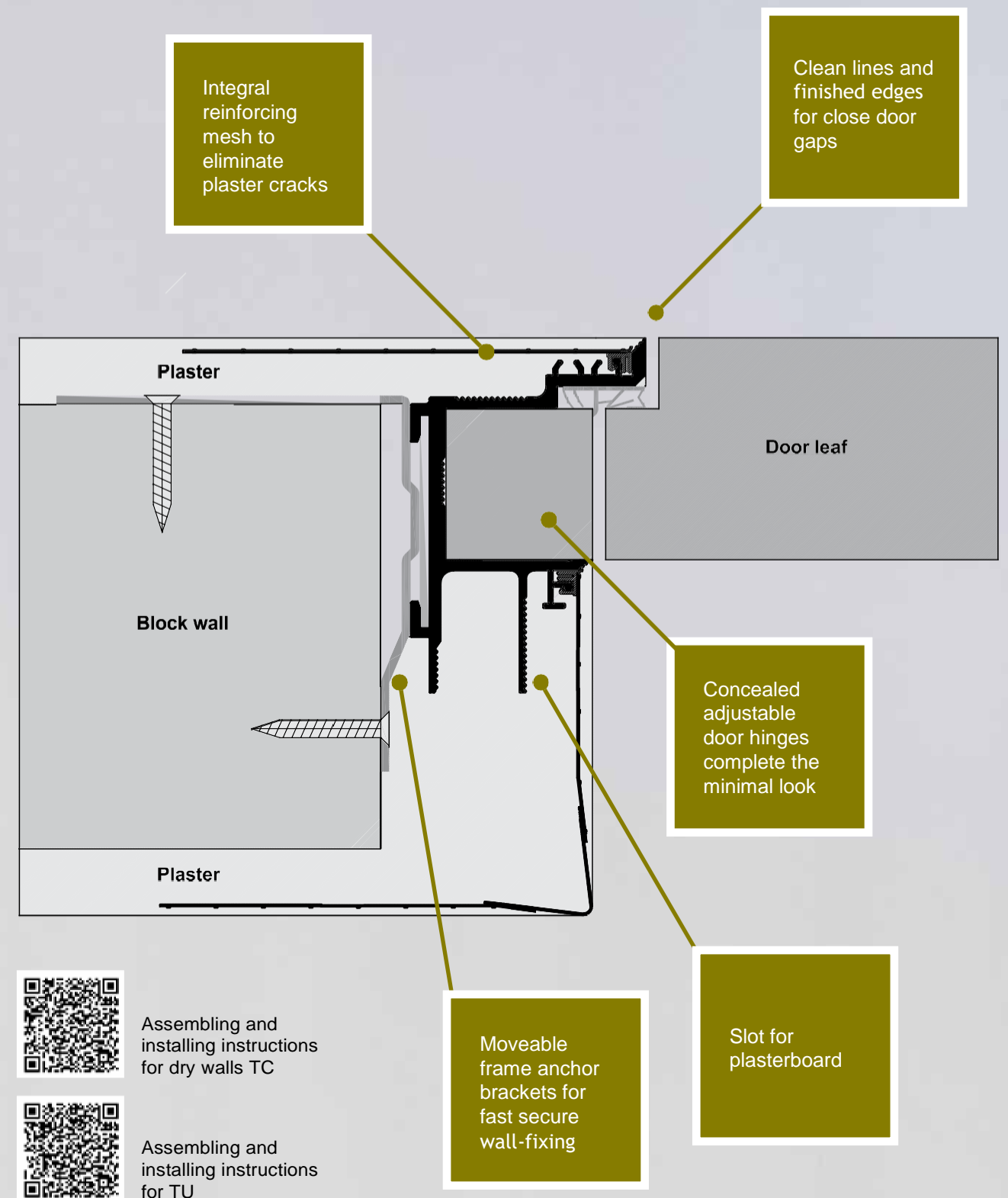

Exclusivity and modern design solution
in our focus

Frame production according to the clients' requirements

Doorframes
for stud and block walls

**Concealed frame
for outward opening doors**

TUT TYPE
for 44 to 65 mm door leaves

For maximum flexibility, 30 min tested by Chiltern Fire. The frame profiles are supplied either meter-cut to size, or loose for cutting and assembly on-site. They are assembled using locking meter corner inserts, temporary corner braces and bottom spreader bar. The frame is then inserted to one side of the opening, attached using moveable brackets. The snap-in mesh ensures no plaster cracks between wall and frame. The door is hung from concealed adjustable hinges set into full-length hard- wood sections inserted on all 3 sides of the frame. Suits standard or floor-to-ceiling doors.

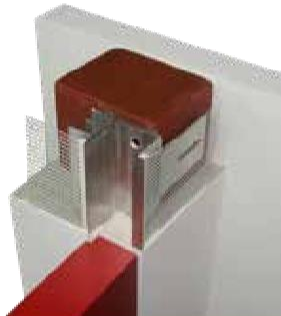
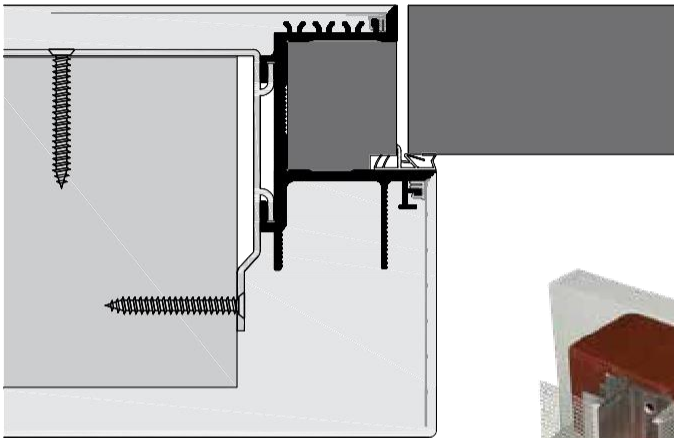

**Concealed frame
for outward opening doors**

TCT TYPE
for 44/45 mm and 50 mm door leaves

The frame profiles are supplied meter-cut to suit door size, and machined to suit concealed hinges, lock strikes and other hardware. They are assembled using locking meter corner inserts, SnapIN corner connectors and bottom spreader bar. The frame is then inserted to one side of the opening, attached using moveable brackets. The snap-in mesh ensures no plaster cracks between wall and frame. The door is hung from concealed adjustable hinges set into the frame. Suits standard or floor-to-ceiling doors.

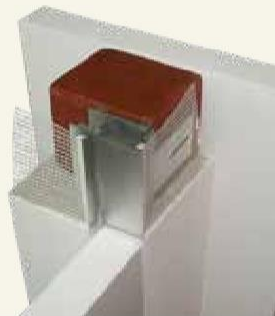
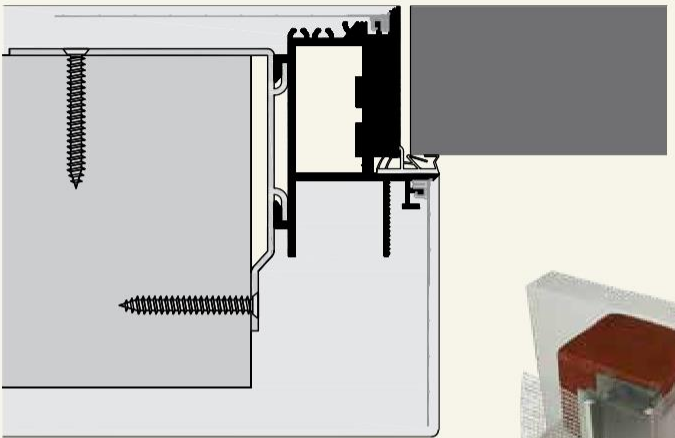

**Concealed frame
for inward opening doors**

TUS TYPE
for 44 to 59 mm door leaves

For maximum flexibility, 30 min tested by Chiltern Fire. The frame profiles are supplied either meter-cut to size, or loose for cutting and assembly on- site. They are assembled using locking meter corner inserts, temporary corner braces and bottom spreader bar. The frame is then inserted to one side of the opening, attached using moveable brackets. The snap-in mesh ensures no plaster cracks between wall and frame. The rebated door is hung from concealed adjustable hinges set into a full- length hardwood sections inserted on all 3 sides of the frame. Suits standard or floor-to-ceiling doors.

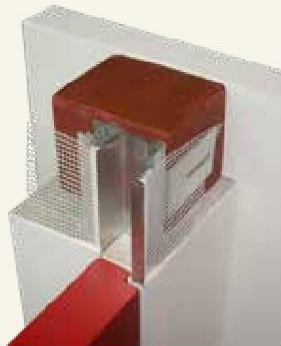
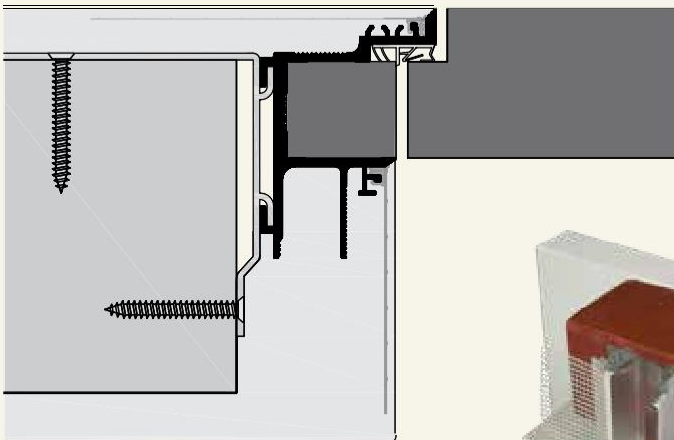

**Concealed frame
for inward opening doors**

TCS TYPE
for 44/45 and 50 mm door leaves

The frame profiles are supplied meter-cut to suit door size, and machined to suit concealed hinges, lock strikes and other hardware. They are assembled using locking meter corner inserts, SnapIN corner connectors and bottom spreader bar. The frame is then inserted to one side of the opening, attached using moveable brackets. The snap-in mesh ensures no plaster cracks between wall and frame. The rebated door is hung from concealed adjustable hinges set into the frame. Suits standard or floor-to-ceiling doors.

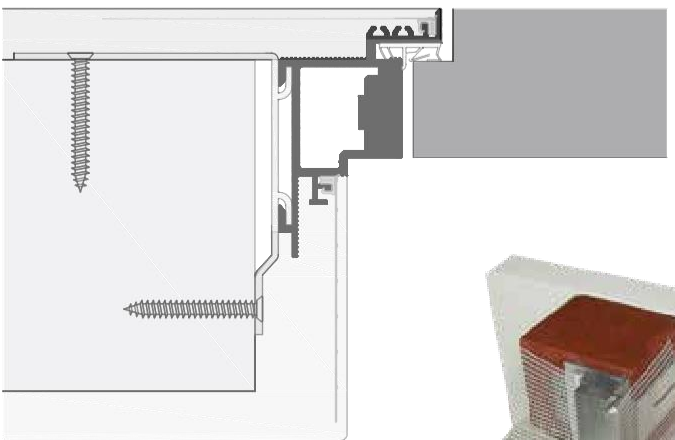

**Concealed frame
for inward/outward
opening doors**

TST TYPE
for 40 and 44 mm door leaves

The frame profiles are supplied meter-cut to suit door size, and machined to suit concealed hinges, lock strikes and other hardware. They are assembled using locking meter corner inserts, SnapIN corner connectors and bottom spreader bar. The frame is then inserted to one side of the opening, attached using moveable brackets. The snap-in mesh ensures no cracks appear between wall and frame. The door is hung from concealed adjustable hinges set into the frame. Suits standard or floor-to-ceiling doors.

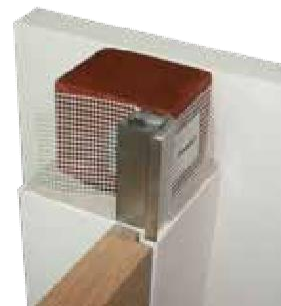
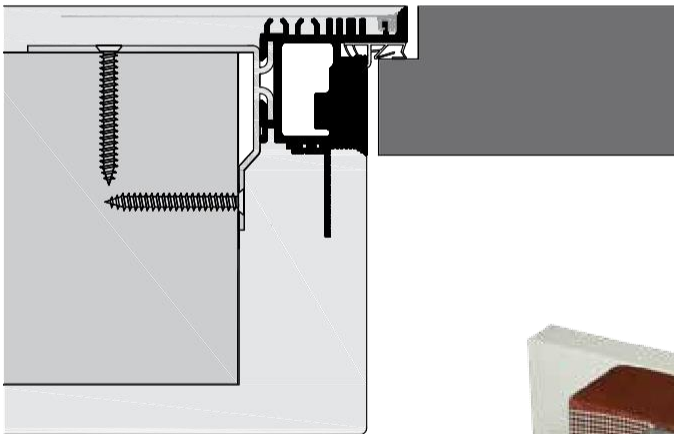

**Concealed frame
for inward opening doors
without recess**

TCS50F TYPE
for 50 mm door leaves

The frame profiles are supplied meter-cut to suit door size, and machined to suit concealed hinges, lock strikes and other hardware. They are assembled using locking meter corner inserts, SnapIN corner connectors and bottom spreader bar. The frame is then inserted to one side of the opening, attached using moveable brackets. The snap-in mesh ensures no plaster cracks between wall and frame. The rebated door is hung from concealed adjustable hinges set into the frame. Suits standard or floor-to-ceiling doors.

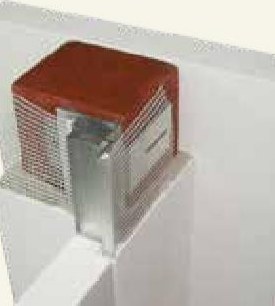
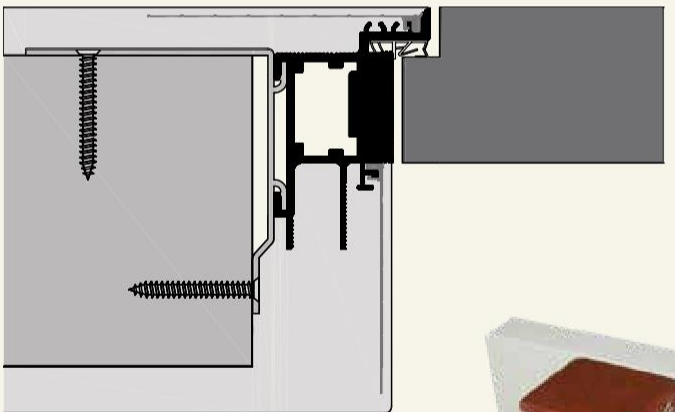

**Shadow gap profile system
for inward/outward opening
timber door frames**

TL TYPE
for 40 to 60 mm door leaves

This profile system is push-fitted onto grooves in the frame linings prior to installing a finished timber door frame, to create the perfect shadow gap outline, and eliminate the need for architraves. The snap-in mesh ensures no plaster cracks between wall and frame. Suits standard or floor-to-ceiling doors.

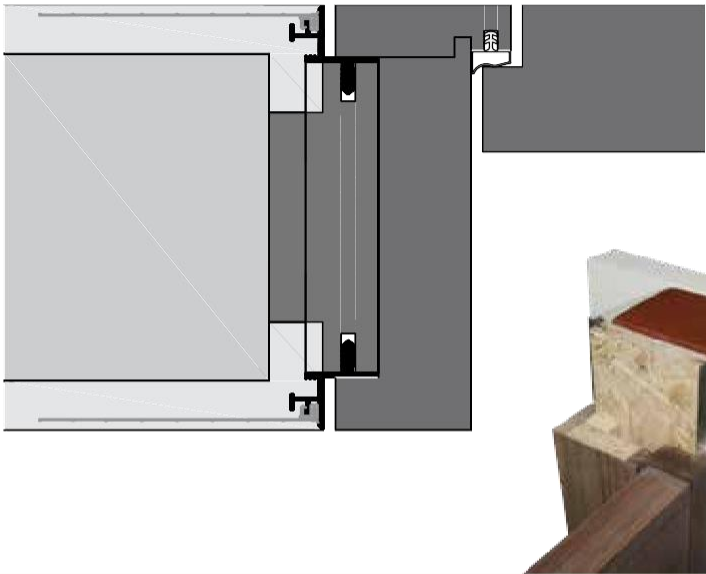

**Shadow gap profile system
for inward/outward opening
timber door frames**

TFN TYPE
for 40 to 60 mm door leaves

This profile system is fitted to the frame linings prior to installing a finished timber door frame, to create the perfect shadow gap outline, and eliminate the need for architraves. The snap-in mesh ensures no plaster cracks between wall and frame. Suits standard or floor-to-ceiling doors.

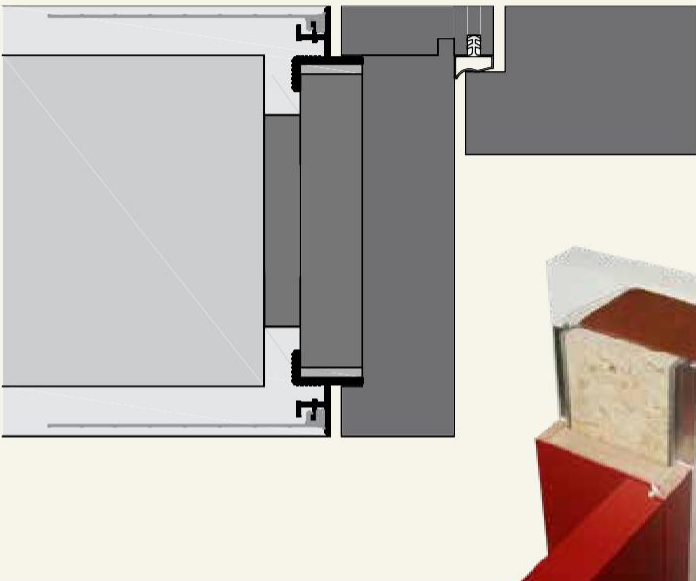

**Concealed sub-frame
for outward opening
timber door frames**

TPL TYPE
for 40 to 65 mm door leaves

The sub-frame profiles are supplied either meter-cut to size, or loose for cutting and assembly onsite. They are assembled using locking meter corner inserts, temporary corner braces and bottom spreader bar. The frame is then inserted to one side of the opening, attached using moveable brackets. The snap-in mesh ensures no plaster cracks between wall and frame. The timber frame and door is hung from the sub-frame. Suits standard or floor-to-ceiling doors.

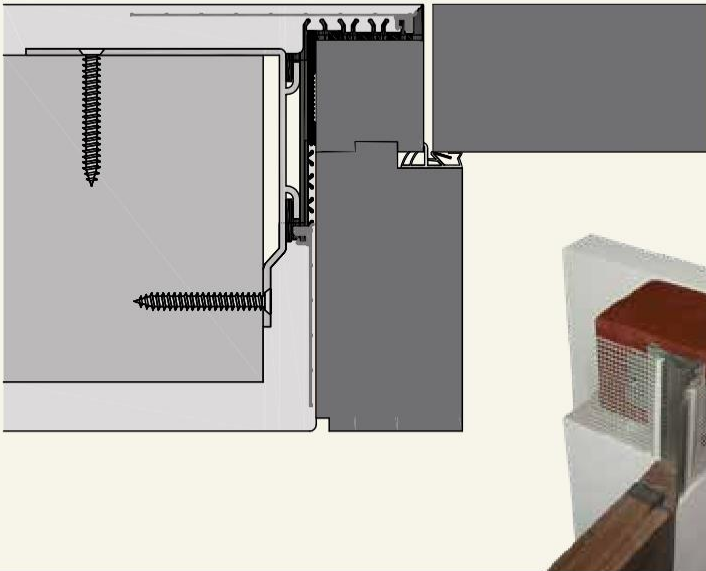

**Concealed sub-frame
for inward/outward opening
timber-framed doors with
shadow gap**

TP TYPE
for 44 to 60 mm door leaves

The sub-frame profiles are supplied either meter-cut to size, or loose for cutting and assembly onsite. They are assembled using locking meter corner inserts, temporary corner braces and bottom spreader bar. The frame is then inserted to one side of the opening, attached using moveable brackets. The snap-in mesh ensures no plaster cracks between wall and frame. The timber frame and door is hung from the sub-frame, creating a shadow gap. Suits standard or floor-to-ceiling doors.

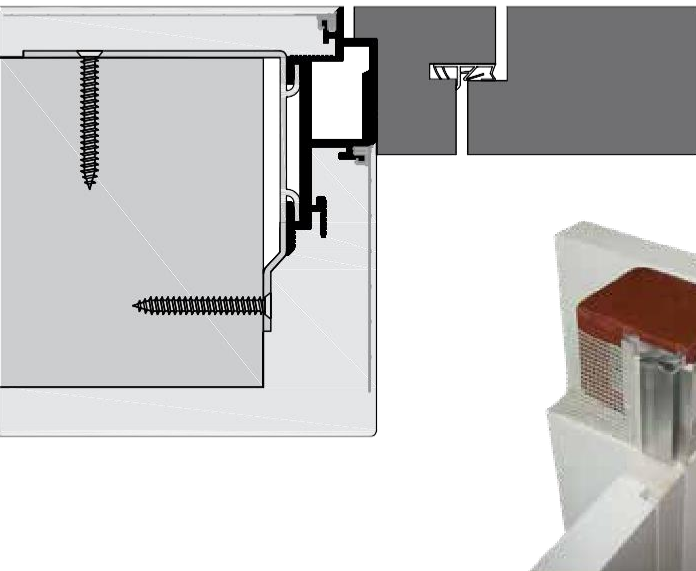

**Concealed sub-frame
for inward opening
timber door frames**

TPS TYPE
for 40 to 65 mm door leaves

The sub-frame profiles are supplied either meter-cut to size, or loose for cutting and assembly on-site. They are assembled using locking meter corner inserts, temporary corner braces and bottom spreader bar. The frame is then inserted to one side of the opening, attached using moveable brackets. The snap-in mesh ensures no plaster cracks between wall and frame. The timber frame and door is hung from the sub-frame. Suits standard or floor-to-ceiling doors.

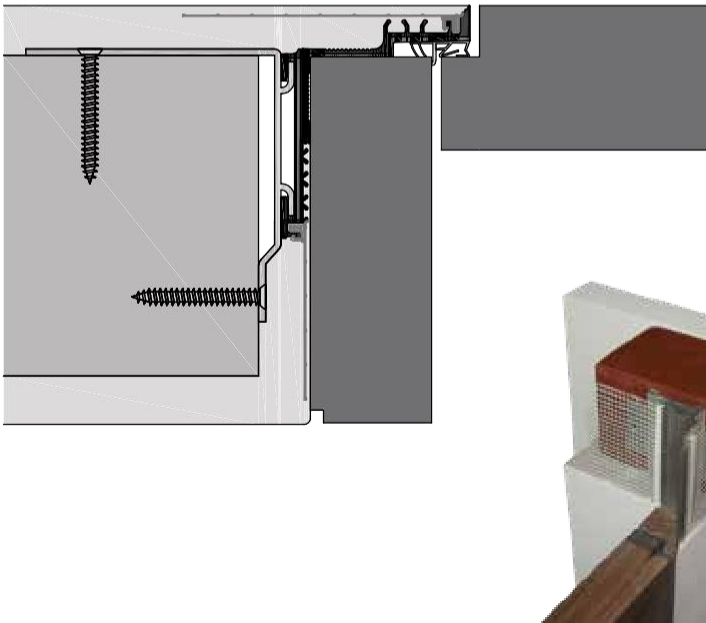

**Concealed frame
for glass doors**

TCG TYPE
for glass doors of 8 and 10 mm

Specially invented for all-glass doors of 8 and 10 mm. The frame profiles are supplied meter-cut to suit door size, and machined to suit concealed hinges, lock strikes and other hardware. They are assembled using locking meter corner inserts, SnapIN corner connectors and bottom spreader bar. The frame is then inserted to one side of the opening, attached using moveable brackets. The snap-in mesh ensures no plaster cracks between wall and frame. The door is hung from concealed adjustable hinges set into the frame. Suits standard or floor-to-ceiling doors.

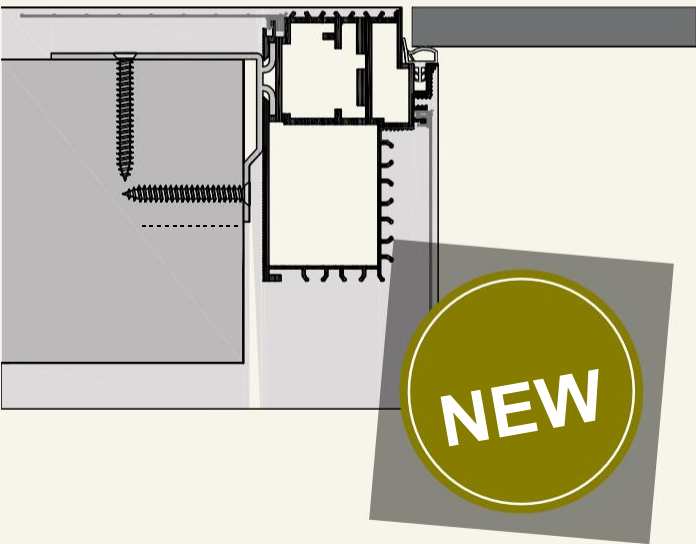



Wall-flush skirting boards

for a uniform appearance

More info provided on www.ags-systems.com



PRODUCT RANGE

Concealed aluminum door frame type TUS
including protective film and mesh support for door leaves of 44/45, 50, 56 and 59 mm - standard profile length 1100, 2200, 2750, 3300 mm

Description	Item no.
TUS45	10445
TUS50	10450
TUS56	10456
TUS59	10459

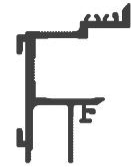

Concealed aluminum door frame type TUT

including protective film and mesh support for door leaves of 44/45, 50, 56 and 59 mm - standard profile length 1100, 2200, 2750, 3300 mm

Description	Item no.
TUT45	10345
TUT59	10359



Concealed aluminum doorframe type TCS

including protective film and mesh support for door leaves of 44/45 and 50 mm maximum door height 3000 mm

Description	Item no.
TCS45	10645
TCS50	10650
TCS50F	10660

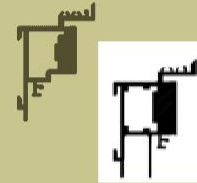

Concealed aluminum door frame type TCT

including protective film and mesh support for door leaves of 44/45 and 50 mm maximum door height 3000 mm

Description	Item no.
TCT45	10545



Concealed aluminum door frame type TST

including protective film and mesh support for door leaves of 40 and 44 mm maximum door height 3000 mm

Description	Item no.
TST40	10740
TST45	10130



Concealed aluminum door frame type TCG

including protective film and mesh support for glass doors of 8 mm maximum door height 3000 mm

Description	Item no.
TCG	10160

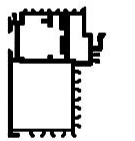

Aluminum sub-frame type TPL

including protective film and mesh support for door leaves of 40 to 65 mm - standard profile length 1100, 2200, 2750, 3300 mm

Description	Item no.
TPL	10150

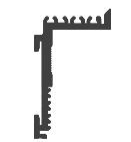

Aluminum sub-frame type TPS

including protective film and mesh support for door leaves of 40 to 65 mm - standard profile length 1100, 2200, 2750, 3300 mm

Description	Item no.
TPS	10140

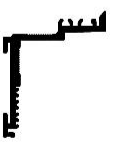

Aluminum sub-frame type TP

including protective film and mesh support for door leaves of 44 to 60 mm - standard profile length 1100, 2200, 2750, 3300 mm

Description	Item no.
TP	10121

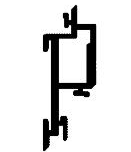

Aluminum shadow gap frame type TFN

including protective film and mesh support for door leaves of 40 to 60 mm - standard profile length 1100, 2200, 2750, 3300 mm

Description	Item no.
TFN	10115



Aluminum shadow gap frame type TL

including protective film and mesh support for door leaves of 40 to 60 mm - standard profile length 1100, 2200, 2750, 3300 mm

Description	Item no.
TL	10110



Bottom spreader bar set (distance spacer)

Description	Item no.
TUT, TUS, TCT, TCS, TP, TPL, TPS	13013
TST, TCG	13053



PVC mesh

suitable for all door frames of AGS systems length 2300mm packaging unit 30 pcs

Item no.
13042

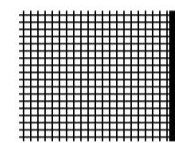

Wall fixing bracket wall thickness < 100

Description	Item no.
TUT, TUS, TCT, TCS, TP, TPL, TPS	13010R100



Corner connector set

Description	Item no.
TUT, TUS, TP, TPL, TPS	13011



KIT corner connectors SnapIN

Description	Item no.
TST	13056
TCT, TCS, TCG	13058



Double-sided adhesive tape

3 mm for TFN profile, coil of 5,50 m

Item no.
50050



Wall fixing bracket wall thickness 100

Description	Item no.
TUT, TUS, TCT, TCS, TP, TPL, TPS	13010 A
TST40	13055
TST45, TCG	13052



Door seal

Description	Item no.
TUT, TUS, TCT, TCS, TP, TPL, TPS, TL, TFN	50096S
black 5,50 m	50097S
black 6,60 m	50096W
white 5,50 m	50097W
white 6,60 m	
TCG	
white 15,00 m	50095

*Excess lengths on request



> Minimal > Aesthetic > Hygienic > Functional > Easy to assemble

More information, sectional drawings as
DWG or PDF file are available on our website
www.ags-systems.com

SDT GROUP INTERNATIONAL AB

Baldersgatan 2A, 3tr

SE-411 02 Göteborg

Tel. +46 31 874 100

Mob. +46 735 230 578

info@sdtgroup.se

www.sdtgroup.se

Trading partner: **Scandinavian Designs Trading AB**

sdt.
— swedish designs trading group international —
BE DIFFERENT

Follow us on

